



SIMONA

BAN HING HOLDING SDN BHD

4 DOORS UPRIGHT FREEZER & CHILLER

Dimension :~

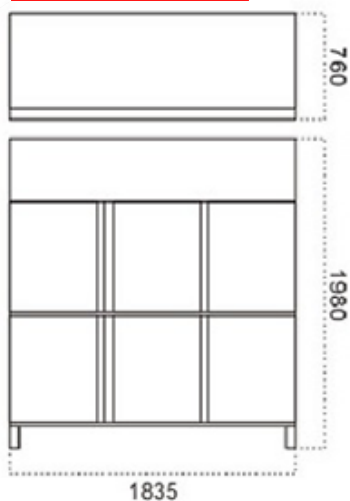

Specification :~

MODEL	CSUF15B6 (Chiller)	CSUF15A6 (Freezer)
CAPACITY	1500L	1500L
TEMPERATURE	+10°C~0°C	0°C~-22°C
REFRIGERANT	R134a	R404a
REFRIGERATION	FAN COOLING	COOLING
DIMENSION (mm)	1835L x 760D x 1980H	1835L x 760D x 1980H

* Designs and specifications are subject to change for improvement without prior notice.

萬興企業有限公司
BAN HING HOLDING SDN BHD

No. 13-3 Jalan Raja Laut, 50350 Kuala Lumpur, Malaysia

Tel: +603 4048 1000

Fax: +603 4050 8000

WEB: www.simona.com.my

Email: enquiry.simona@gmail.com