

Tool Steel Single Ended Beam Load Cells

MBS Series

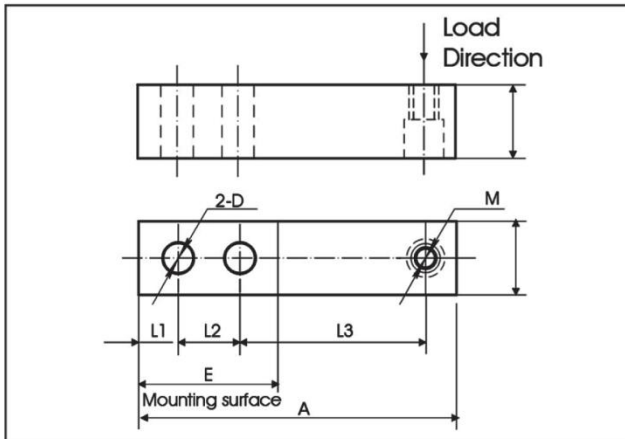

Dimension:



Capacity	A	B	D	E	L1	L2	L3	M
250-4klb	5.12	1.25	0.53	2.25	0.62	1.00	3.00	1/2-20UNF-2B
10klb	6.75	1.50	0.78	3.00	0.75	1.50	3.75	3/4-16UNF-2B
20klb	8.88	2.00	1.03	4.00	1.00	2.00	4.88	1 1/4-12UNF-2B
500kg-2t	130	32	13	57	16	25	76	M 12
5t	171	38	21	76	19	38	95	M 20
10t	226	51	25	102	25	51	124	M 24 X 2

Specification :~

MODEL	MBS
CAPACITY	250,500, 1k,2k,4k,10k,20klb,500,1000,2000 ,5000,10000kg
SENSITIVITY	3± 0.01%
ZERO BALANCE	< 2% of Full Scale
CREEP (1 HOUR)	< 0.03% of Full Scale
NON-LINEARITY	< 0.03% of Full Scale
HYSTERESIS	< 0.03% of Full Scale
REPEATABILITY	< 0.02% of Full Scale
TEMPERATURE EFFECT ON OUTPUT	< 20 PPM/°C of Applied Load
TEMPERATURE EFFECT ON ZERO	< 20 PPM/°C of Applied Load
OPERATING TEMPERATURE RANGE	-20°C to 60°C
COMPENSATED TEMPERATURE RANGE	-10°C to 50°C
SAFE OVERLOAD	1.5 x Capacity
INPUT IMPEDANCE	400 ± 10 Ohms
OUTPUT IMPEDANCE	350 ± 3 Ohms
INSULATION RESISTANT	> 2,000 Meg- Ohms
RECOMMENDED EXCITATION	10 V DC/AC
MAXIMUM EXCITATION	15 V DC/AC
CABLE LENGTH	6 m
ENVIRONMENTAL PROTECTION	IP 68

Cable Color Code

Red	+ Excitation
Black	- Excitation
Green	+ Signal
White	- Signal

* Designs and specifications are subject to change for improvement without prior notice.

BAN HING HOLDING SDN BHD

No. 13-3, Jalan Raja Laut, 50350 Kuala Lumpur, Malaysia.

Tel: 603-4048 1000 / 4042 5970

Fax: 603-4050 8000

Website: www.banhing.com

Email: enquiry@banhing.com