

Low Profile Disk Load Cells

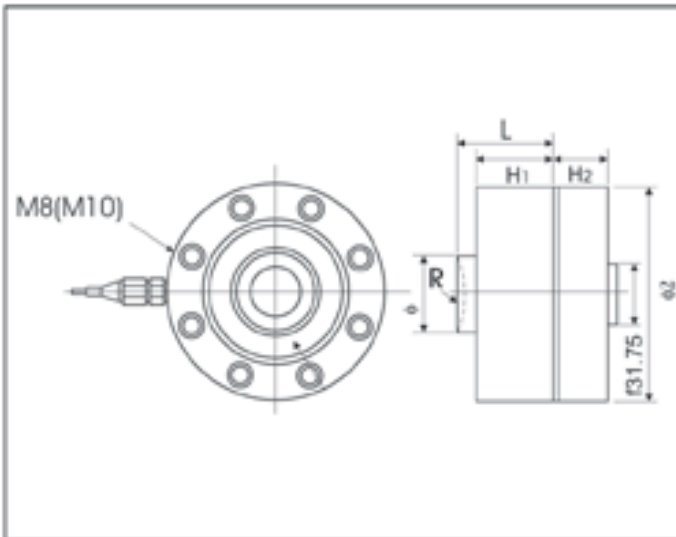

Dimension:



Rated Load	Size: mm					
	O	R	L	H1	H2	O2
Lb	0	22	54	47	24	121
25-50K	41	22	54	47	24	121
100K	51	22	57	51	29	140

Load Cell Specification:

Model	MPD
Capacity	25k, 50k, 100k lb
Sensitivity MV/V	4mV/V \pm 0.01%
Zero Balance	< 2% of Full Scale
Creep (1 hour)	< 0.03% of Full Scale
Non-linearity	< 0.03% of Full Scale
Hysteresis	< 0.03% of Full Scale
Repeatability	< 0.02% of Full Scale
Temperature effect on Output	< 20PPM / °C of Applied Load
Temperature effect on zero	< 20PPM / °C of Applied Load
Operating temperature range	- 20 °C to 60 °C
Compensated temperature range	- 10 °C to 50 °C
Safe Overload	1.5 x Capacity
Input Impedance	400 \pm 10 Ohms
Output Impedance	350 \pm 5 Ohms
Insulation Resistant	> 5,000 Meg - Ohms
Recommended Excitation	10 V DC/AC
Maximum Excitation	15 V DC/AC
Cable Length	20 m
Environmental Protection	IP 67

Cable Color Code

Red	+ Excitation
Black	- Excitation
Green	+ Signal
White	- Signal

* Designs and specifications are subject to change for improvement without prior notice.

BAN HING HOLDING SDN BHD

No. 13-3, Jalan Raja Laut, 50350 Kuala Lumpur, Malaysia.

Tel: 603-4048 1000 / 4042 5970

Fax: 603-4050 8000

Website: www.banhing.com

Email: sales@banhing.com